

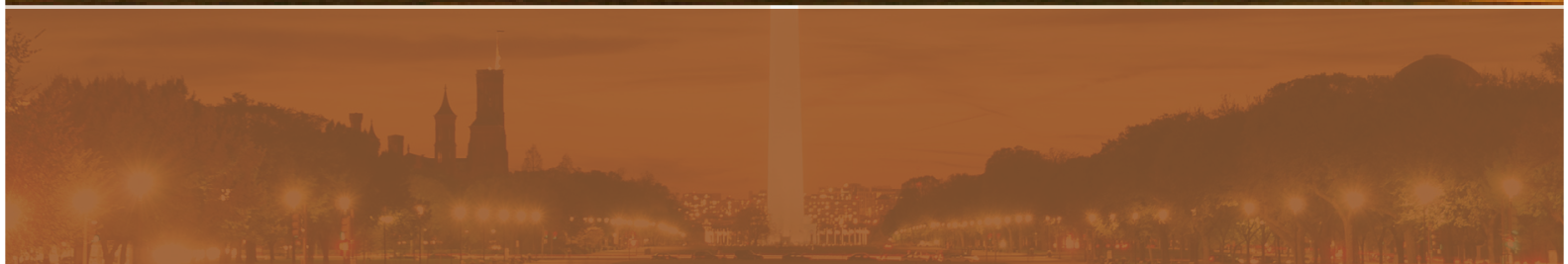

ADMINISTRATION FOR
CHILDREN & FAMILIES

Tribal TANF Summit

August 31 - September 1, 2015
Washington, District of Columbia



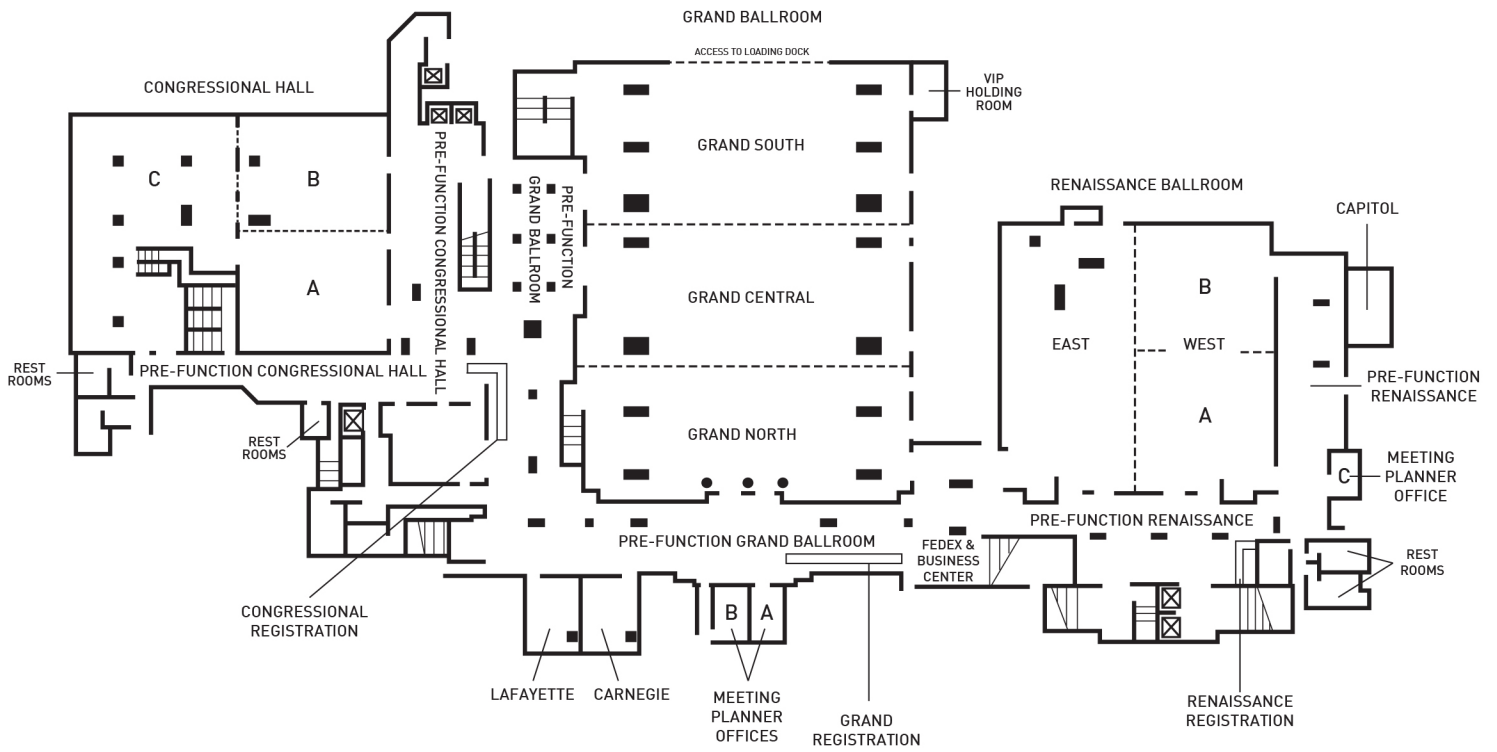

BALLROOM LEVEL

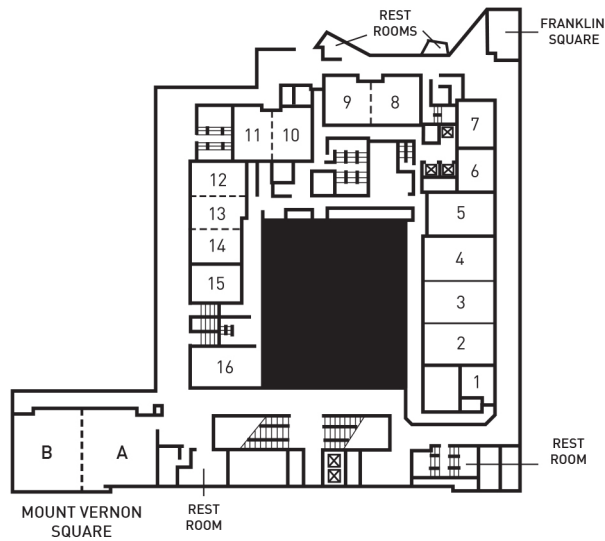

MEETING ROOM LEVEL



ADMINISTRATION FOR
CHILDREN & FAMILIES

370 L'Enfant Promenade, S.W., Washington, DC 20447 www.acf.hhs.gov

August 31, 2015

Greetings,

On behalf of the U.S. Department of Health and Human Services, Administration for Children and Families, Office of Family Assistance (OFA), it is our pleasure to welcome you to the Washington DC area for the Tribal TANF Summit. This Summit is designed to bring together tribal leaders and Tribal TANF program administrators from more than 70 tribes, along with experts from the field to share innovative strategies and updates related to Tribal TANF program implementation.

During our time together, OFA will share valuable program-related information with tribal leaders and Tribal TANF administrators. Leaders will have an opportunity to hear from tribal and state peers who are navigating similar issues and challenges as they work to meet the needs of those being served in Indian Country. This meeting, which is aimed to enhance and improve program performance, will provide technical assistance, guidance, and program related information to Tribal TANF administrators.

The *Tribal TANF Summit* will provide a number of excellent opportunities for you and your colleagues administering Tribal TANF programs to learn from each other by sharing promising practices and strategies for addressing barriers for the individuals served by your programs.

We look forward to an inspiring, valuable and informative Summit. We appreciate your dedication and commitment to improving the lives of tribal families and communities. Thank you again for joining us, we hope that you have a wonderful stay.

Sincerely,

Felicia Gaither, Ph.D.
Director, Division of Tribal TANF Management
U.S. Department of Health and Human Services
Administration for Children and Families
Office of Family Assistance



2015 TRIBAL TANF SUMMIT AGENDA

AUGUST 31, 2015-SEPTEMBER 1, 2015 | WASHINGTON, DC

MONDAY, AUGUST 31, 2015

8:30 a.m.—9:00 a.m.

Welcome and Tribal Opening

Renaissance Ballroom

Nisha Patel, *Director, Office of Family Assistance, Administration for Children and Families, U.S. Department of Health and Human Services*

Felicia Gaither, *Director, Division of Tribal TANF Management, Office of Family Assistance, Administration for Children and Families, U.S. Department of Health and Human Services*

Lester Alford, *Tribal TANF Executive Director, Karuk Tribe of California*

9:00 a.m.—10:15 a.m.

WIOA Implementation in Tribal Areas and Investing in our Youth and the Community: Summer Youth Employment Programs in Indian Country

During this session, representatives from the Department of Labor will discuss the rollout of the Workforce Innovation and Opportunity Act of 2014 (WIOA) and how it relates to tribal communities. The session will also feature information on summer youth employment opportunities, including an example from a Tribal TANF program that has successfully engaged youth in employment.

Athena Brown, *Division Chief, U.S. Department of Labor, Employment and Training Administration, Division of Indian and Native American Programs*

Amanda Ahlstrand, *Administrator, Office of Workforce Investment, Employment and Training Administration, United States Department of Labor*

Matthew Barnes, *Program Services Director, California Tribal TANF Partnership Administration*

Moderator:

Stan Koutstaal, *Program Manager, Health Profession Opportunity Grants, Office of Family Assistance, Administration for Children and Families, U.S. Department of Health and Human Services*

10:15 a.m.—10:30 a.m.

BREAK

10:30 a.m.—12:00 p.m. *What Can Tribes Do? Strategies and Institutions in American Indian Economic Development*

This session will provide tribes with insight and information on the link between governance and economic development as well as how Tribal TANF plays a role in this relationship. Dr. Stephen Cornell will discuss the experiences, findings, and guiding principles emerging from the work of the Harvard American Indian Economic Development organization in assisting tribes to develop policies and governance structures that support and drive economic development efforts. Mr. Joseph Nayquonabe will share his experiences leading the Mille Lacs Corporate Ventures, an entity created by the tribal government of the Mille Lacs Band of Ojibwe, in developing and nurturing a wide range of business efforts in east-central Minnesota. Mr. Nayquonabe will discuss the importance of diversification in economic development (both gaming and non-gaming ventures) and touch on his organization’s connection to Tribal TANF.

Stephen Cornell, *Co-Director of the Harvard Project on American Indian Economic Development & Director, Udall Center for Studies in Public Policy, University of Arizona*

Joseph Nayquonabe, *Chairman of the Board and Commissioner of Corporate Affairs, Mille Lacs Corporate Ventures*

Moderator:

Denise Litz, *Family Assistance Program Specialist, Office of Family Assistance, Administration for Children and Families, U.S. Department of Health and Human Services*

12:00 p.m.—1:30 p.m. *LUNCH ON YOUR OWN*

1:30 p.m.—3:00 p.m. *Peer Networking*

Attendees will have the opportunity to engage in small group dialogue with their peers around core issues facing Tribal TANF programs and Native communities. Table topics will include:

- *Economic Development*
- *Summer Youth Employment and Job Creation*
- *Evaluation and Program Assessment*
- *Job Advancement/Development*
- *Health Insurance Marketplace*
- *Data Management and Performance Measurements*
- *Tribal TANF Success Stories*

Following the small group discussions, attendees will have the opportunity to share key lessons learned.

Moderator:

Lynn Carrier, *Senior Associate, ICF International*

3:00 p.m.—3:15 p.m.

BREAK

3:15 p.m.—5:00 p.m.

Successful Tools for Case Managers

Case managers are tasked with many functions in building a successful program. They must motivate, assess customers, write career plans, help customers become employed and follow-up post placement. This session will cover a variety of tools and strategies for helping case managers be efficient and effective.

Jodie Sue Kelly, Co-Founder, Cygnet Associates

Moderator:

Liliana Hernandez, Program Specialist, Office of Family Assistance, Administration for Children and Families, U.S. Department of Health and Human Services

5:00 p.m.

Informal Networking

TUESDAY, SEPTEMBER 1, 2015

- 8:30 a.m.—8:45 a.m. Renaissance Ballroom** **Day Two Welcome and Tribal Opening**
- Felicia Gaither**, *Director, Division of Tribal TANF Management, Office of Family Assistance, Administration for Children and Families, U.S. Department of Health and Human Services*
- Dennis Zotigh**, *Cultural Specialist, Smithsonian’s National Museum of the American Indian*
- 8:45 a.m.—10:00 a.m.** **Listening Session**
- The listening session will provide tribes and states with an opportunity to voice their shared questions, comments, and concerns to Administration for Children and Families (ACF) leadership on its vision to serve the needs of Native American children, families and communities.
- Listening Panel:**
- Mark Greenberg**, *Acting Assistant Secretary, Administration for Children and Families, U.S. Department of Health and Human Services*
- Lillian Sparks Robinson**, *Commissioner, Administration for Native Americans, Administration for Children and Families, U.S. Department of Health and Human Services*
- Nisha Patel**, *Director, Office of Family Assistance, Administration for Children and Families, U.S. Department of Health and Human Services*
- Moderator:**
- Felicia Gaither**, *Director, Division of Tribal TANF Management, Office of Family Assistance, Administration for Children and Families, U.S. Department of Health and Human Services*
- 10:00 a.m.—10:50 a.m.** **Building Tribal and State Relations**
- This session will highlight strategies for building coalitions as both states and tribes work toward the goals of building self-sufficiency and ensuring well-being for families. The panelists will discuss how shared goals for children and families can serve as the foundation for collaboration, and will share examples of successful tribal and state coalitions.
- Lesa Evers**, *Tribal Relations Manager, Montana Department of Public Health and Human Services*
- Anita Fineday**, *Managing Director, Indian Child Welfare Programs, Casey Family Programs*
- Moderator:**
- Heather Zenone**, *Senior Advisor, Tribal Children, Children’s Bureau, Administration for Children and Families, U.S. Department of Health and Human Services*
- 10:50 a.m.—11:00 a.m.** **BREAK**

- 11:00 a.m.—11:45 a.m. *Building Tribal and State Relations Breakout Sessions***
- Federal staff and panelists from the Building Tribal and State Relations session will meet with tribal and state representatives grouped by Region to discuss strategies for successful coalition building around issues such as tribal consultation and child welfare. These smaller groups will allow tribes an opportunity to meet one-on-one with their state peers, as well as think about areas of potential technical assistance and guidance that would help them partner for better outcomes for children and families.
- Renaissance Ballroom *Regions I, II, IV, V, VII, and X***
- Moderators:**
- Heather Zenone**, *Senior Advisor, Tribal Children, Children’s Bureau, Administration for Children and Families, U.S. Department of Health and Human Services*
- Lillian Sparks Robinson**, *Commissioner, Administration for Native Americans, Administration for Children and Families, U.S. Department of Health and Human Services*
- Mount Vernon AB *Regions VI, VIII, and IX***
- Moderators:**
- Lesa Evers**, *Tribal Relations Manager, Montana Department of Public Health and Human Services*
- Anita Fineday**, *Managing Director, Indian Child Welfare Programs, Casey Family Programs*
- 11:45 a.m.—1:00 p.m. *ADJOURN/LUNCH ON YOUR OWN***
- 1:00 p.m.—1:15 p.m. *Opening Remarks—Gateway to Opportunity: Improving Parental Employment and Family Well Being Outcomes***
- 1:15 p.m.—5:00 p.m. *Gateway to Opportunity Workshops (for State and Tribal TANF Summit participants)***



Matthew Barnes has worked to improve the lives of Native American children and families for over 10 years. He started as the director of the first Native American Boys & Girls Club in California, became site manager for California Tribal TANF Partnership (CTTP) and is now program services director for CTTP. As program services director, Mr. Barnes oversees teen pregnancy prevention, workplace success, work experience, and youth employment programming for CTTP's 16 counties, serving 18 partner tribes as well as unaffiliated federally recognized tribal members and California Judgment Roll participants. Mr. Barnes earned his bachelor of social work from the Humboldt State University.

Stephen Cornell is professor of sociology and director of the Udall Center for Studies in Public Policy at the University of Arizona. He co-founded and continues today to co-direct the Harvard Project on American Indian Economic Development; he also led the development of the Native Nations Institute at Arizona, a partner program to the Harvard Project. Dr. Cornell has spent much of the last 25 years working with Native nations in the United States, Canada, Australia, and New Zealand on self-determination, governance, and development issues.

Jodie Sue Kelly has been in the workforce development field for over three decades. She is a popular speaker at national, regional, and local conferences. She was awarded the 2004 National Association of Workforce Development Professional of the Year award. Ms. Kelly has a master's degree from George Mason University in information systems and an undergraduate degree from California University of Pennsylvania in psychology.

Athena R. Brown is an enrolled member of the Ft. McDermitt Paiute/Shoshone Tribe in northern Nevada. Ms. Brown currently serves as the chief of the Division of Indian and Native American Programs, Office of Workforce Investment, Employment and Training Administration, U.S. Department of Labor. She formerly served as the superintendent of the Western Nevada Agency, Bureau of Indian Affairs, U.S. Department of the Interior from October 2007 to August 2014 in Carson City, NV. She also served as the chief of staff to the director of the Bureau of Indian Education in Washington, DC. Ms. Brown recently returned to the Washington, DC area to serve as the division chief. She has vast experience working with Indian Country in various fields including employment and training, Public Law 93-638, tribal operations, and economic development, and she has worked for the private sector, national Indian organizations, and tribal and federal organizations.

Amanda Ahlstrand joined the U.S. Department of Labor's Employment and Training Administration in January 2003 and currently serves as the administrator for the Office of Workforce Investment. As such, she provides federal oversight and leadership for the nation's workforce investment system, authorized by the Workforce Innovation and Opportunity Act (WIOA). In addition to WIOA programs, she has responsibility for implementing the Senior Community Service and Employment program, H-1B Technical Skills Training grants, and the Trade Adjustment Assistance Community College and Career Training program. As federal partners in this system, she and her talented team work to ensure that both job seeker and business customers are at the center of service delivery across programs designed to serve employers, unemployed and dislocated workers, youth, Indians and Native Americans, farmworkers, people with disabilities, and others.

Ms. Ahlstrand has also served as the division chief for Strategic Investments and as a team lead for the Employment and Training Administration (ETA) Performance and Results Office. Prior to joining ETA, Ms. Ahlstrand worked for a private consulting firm, the U.S. Government Accountability Office, and the American Society for Training and Development. Ms. Ahlstrand has a bachelor of arts degree in economics and sociology from the University of Notre Dame and a master of public policy degree from Georgetown University.

Joseph Nayquonabe Jr. is the commissioner of corporate affairs and CEO of Mille Lacs Corporate Ventures (MLCV). As CEO, Mr. Nayquonabe serves as the chairman of the board of directors for Mille Lacs Corporate Ventures, which analyzes new business opportunities and oversees the Mille Lacs Band's existing businesses, including Grand Casino Mille Lacs, Grand Casino Hinckley, the Crowne Plaza St. Paul Riverfront Hotel, the DoubleTree by Hilton in St. Paul, MN, the Embassy Suites in Oklahoma City, Eddy's Resort on Lake Mille Lacs, Sweetgrass Media, 2020 Brand Solutions, and numerous small businesses. When Mr. Nayquonabe assumed the role of CEO, he made the boldest move in the company's history when he directed MLCV to grow its non-gaming revenue streams and invest in hospitality and marketing industries. Since then, non-gaming revenue has grown more than 236% and non-gaming cash flow has increased by 1,191%. In addition to his work, Mr. Nayquonabe serves on the Friends of Como Zoo board of directors, the American Indian Advisory Board for St. Cloud State University, Minnesota Lodging Association, and the American Red Cross Minnesota Region Board of Directors.

Felicia Gaither is the director for the Division of Tribal TANF of the Administration for Children and Families' Office of Family Assistance (OFA), part of the U.S. Department of Health and Human Services. Dr. Gaither is responsible for the oversight and administration of the Tribal TANF Program, Native Employment Works Program, and the Tribal TANF Child Welfare discretionary grant program, providing technical assistance and guidance to regional offices, states, and tribes administering the TANF program throughout the nation. Previously, Dr. Gaither served as the Region VIII-Denver Program Manager in OFA, where she was responsible for providing technical assistance and guidance to state and tribal administrators in Colorado, Montana, Utah, Wyoming, South Dakota, and North Dakota. Dr. Gaither has years of experience working in human services. She has served in many capacities working for a variety of organizations at the local, state, and federal levels. Dr. Gaither received her bachelor's degree in political science from the University of Nebraska, a master's degree in public administration from Wichita State University, and a Ph.D. in human services from Capella University.

Dennis W. Zotigh is a Kiowa, San Juan Pueblo, and Santee Dakota Indian and is a member of the Kiowa Gourd Clan and a descendent of Sitting Bear and No Retreat, both principal war chiefs of the Kiowa. He is the director of the internationally known dance company, The Great American Indian Dancers. As a performer and lecturer, Mr. Zotigh has toured 49 states and 21 foreign countries. As both an Indian dancer and singer, he has competed and won numerous awards for his talents. He currently sings with the former world champion Indian singing group The Zotigh Singers. Prior to joining the staff of National Museum of the American Indian, Mr. Zotigh played an important role in developing the American Indian Gallery of the new Oklahoma History Center in Oklahoma City, OK in the capacity of American Indian researcher and historian. Mr. Zotigh truly seeks to preserve the past, to broaden how Native Americans are viewed in the present, and to create new opportunities for Indian youth in the future.

Mark Greenberg is the acting assistant secretary for the Administration for Children and Families. He also serves as both the principal deputy assistant secretary and the acting commissioner for the Administration on Children, Youth and Families. Before joining HHS, Mr. Greenberg directed the Georgetown University Center on Poverty, Inequality, and Public Policy, a joint initiative of the Georgetown University Law Center and the Georgetown Public Policy Institute. In addition, he was a senior fellow at the Center for American Progress (CAP) and the Center for Law and Social Policy (CLASP). He previously served as the executive director of CAP's Task Force on

Poverty and as CLASP's director of policy. During his career, Mr. Greenberg has written extensively on issues relating to federal and state welfare reform efforts, workforce policy issues affecting low-income families, child care and early education policy, tax policy, poverty measurement, and a range of other low-income issues. In addition, he frequently provided technical assistance to state and local governments regarding poverty reduction strategies. Prior to coming to DC, Mr. Greenberg worked at Jacksonville Area Legal Aid in Florida and the Western Center on Law and Poverty in Los Angeles, CA. Mr. Greenberg is a graduate of Harvard College and Harvard Law School.

Lillian Sparks Robinson, a Lakota woman of the Rosebud and Oglala Sioux Tribes, is the commissioner of the Administration of Native Americans. She has devoted her career to supporting the educational pursuits of Native American students, protecting the rights of indigenous people, and empowering tribal communities. Prior to her appointment, Ms. Sparks served as the executive director of the National Indian Education Association (NIEA) where she worked extensively on K-12 and early childhood education policy and appropriations impacting American Indian, Alaska Native, and Native Hawaiian students. Before joining NIEA, Ms. Sparks served as a staff attorney with the National Congress of American Indians, where she worked on international indigenous rights, sacred sites and religious protection, and issues related to youth and healthcare. Ms. Sparks also previously worked in the legal department at the National Indian Gaming Commission at the Department of the Interior. Ms. Sparks received her bachelor's degree in political science from Morgan State University, located in her hometown of Baltimore, MD, and her *juris doctor* from Georgetown University Law Center in Washington, DC. Ms. Sparks is admitted to practice in Maryland.

Nisha Patel is the director of the Office of Family Assistance. Ms. Patel has nearly two decades of experience developing, managing, and implementing initiatives to increase economic opportunities for low-income families in the US. She was most recently deputy director of Ascend at the Aspen Institute, where she played a key role in national efforts to expand two-generation approaches to improve outcomes for children and their parents. Prior to the Aspen Institute, Ms. Patel was a program officer in the U.S. Program at the Bill & Melinda Gates Foundation, where she managed a \$40 million portfolio focused on reducing inequity and increasing postsecondary success through community partnerships and policy development. She previously held positions as director of programs at Washington Area Women's Foundation and senior policy analyst at the Center for Law and Social Policy, where she co-authored numerous publications and provided technical assistance to states and communities focused on welfare reform, workforce development, and work supports for low-income families. Earlier, Ms. Patel worked at the National Legal Aid and Defender Association. She has also served as an adjunct professor at the George Washington University. Ms. Patel is a graduate of Vanderbilt University and holds a master of social work with a concentration in social and economic development from Washington University in St. Louis.

Lesia Evers currently serves as the tribal relations manager for the Department of Public Health and Human Services, a position she has held since January 2013. In this capacity, she helps guide the department's internal and external work with tribal governments, tribal health programs, and Indian people. Previously, she was appointed by Governor Brian Schweitzer to serve as his state director of Indian affairs from June 2010 to January 2013 and as the economic development specialist for Indian Country for the Governor's Office of economic development from July 2008 to June 2010. Ms. Evers has held other state government positions such as the Indian Country Economic Development program manager for the Department of Commerce and as the executive assistant to the director of the Montana Department of Agriculture. In addition, Ms. Evers worked for the Blackfeet Higher Education Program, State of Alaska, and the Alaska Job Corps Center.

Ms. Evers was born on the Blackfeet Reservation in Browning, MT. She is of Blackfeet descent and is an enrolled member of the Turtle Mountain Band of Chippewa. She attended college at Montana State University in Bozeman and Matanuska Susitna College in Palmer, AK.

Anita Fineday became the managing director of the Indian Child Welfare Program for the Casey Family Programs in 2011. She previously served as the chief judge for the White Earth Tribal Nation for 14 years. She holds a master's degree in public administration from the Harvard University's Kennedy School of Government and a *juris doctor* from the University of Colorado School of Law. She has previously served as an associate judge for the Leech Lake Band of Ojibwe and the Grand Portage Band of Chippewa. She has also taught federal Indian law and policy at the tribal college, university, and law school levels. She is an enrolled member of the White Earth Tribal Nation.



2015 Tribal TANF Summit

TRIBAL REPRESENTATIVES

Maria A. Aguirre

TANF Director

Soboba Tribal TANF Program
Soboba Band of Luiseno Indians
1425 Spruce Street, Suite A
Riverside, California 92507
Phone: 951-654-5964
Email: maguirre@soboba-nsn.gov

Leann M. Babcock McCallum

Program Manager

Community and Family Services
Smith River Rancheria
140 Rowdy Creek
Smith River, California 95531
Phone: 707-487-9255
Email: leann.babcock@tolowa.com

Lester L. Alford

Executive Director

TANF Program
Karuk Tribe
P.O. Box 1016
Happy Camp, California 96039
Phone: 530-493-1600
Email: mallec@karuk.us

Kurtis Barker

477 Self Sufficiency Program Director

Confederated Tribe of Siletz Indians
P.O. Box 549
Siletz, Oregon 97380
Phone: 541-444-8247
Email: kurtisb@ctsi.nsn.us

Leon Aragon

Supervising Director

Santo Domingo Pueblo
P.O. Box 152
Santo Domingo Pueblo, New Mexico 87106
Phone: 505-328-2737
Email: laragon@kewa-nsn.us

Glenn N. Basconcillo

TANF Program Consultant

North Fork Rancheria
33143 Road 222
P.O. Box 929
North Fork, California 93643
Phone: 559-877-2461
Email: gbasconcillo@gnbcinc.com

Rebecca Benton

General Assistance/TANF Director

Department of Human Services
Red Cliff Band of Lake Superior Chippewa
88385 Pike Road Highway 13
Bayfield, Wisconsin 54814
Phone: 715-779-3706
Email: rbenton@redcliff-nsn.gov

Bryan Blackburn

Program Manager

South Puget Intertribal Planning Agency
3104 Southeast Old Olympic Highway
Shelton, Washington 98584
Phone: 360-429-3990
Email: bblackburn@spipa.org

Marilyn W. Blythe

Executive Manager

Family Services in Indian Country
Tribal TANF Program
Eastern Band of Cherokee Indians
1526 Acquoni Road
P.O. Box 427
Cherokee, North Carolina 28719
Phone: 828-497-4317
Email: ablythe@1fsic.com

Scott Boyle

Director

TANF Program
Federated Indians of Graton Rancheria
6400 Redwood Drive, Suite 110
Rohnert Park, California 94928
Phone: 707-566-2288
Email: sboyle@gratonrancheria.com

Gertrude Brown

Chairwoman

Owens Valley Career Development Center
2574 Diaz Lane
P.O. Box 847
Bishop, California 93515
Phone: 760-873-5107
Email: gellis@ovcdc.com

Yvette R. Buckley

Director

Spokane Tribe of Indians
P.O. Box 100
Wellpinit, Washington 99040
Phone: 509-413-8389
Email: yvetteb@spokanetribe.com

Frank Canizales

Director

Department of Social Services
Tuolumne Band of Me-Wuk Indians
19595 Mi-Wu Street
P.O. Box 615
Tuolumne, California 95379
Phone: 209-928-5316
Email: fcanizales@mewuk.com

Sandra L. Carley

Program Manager

TANF Program
Lac Courte Oreilles Chippewa Tribe
13394 West Trepania Road
Hayward, Wisconsin 54843
Phone: 715-634-8934
Email: sandycarley@yahoo.com

Shonta L. Chaloux

Director

Tribal TANF Program
Pechanga Band of Luiseno Indians
P.O. Box 1477
Temecula, California 92593
Phone: 951-770-6164
Email: schaloux@pechanga-nsn.gov

Katy Ciotti

TANF Director

Morongo Tribal TANF Program
Morongo Band of Mission Indians
161 West Ramsey Street
P.O. Box 1268
Banning, California 92220
Phone: 951-755-5178
Email: kciotti@morongo-nsn.gov

Marlinda Clendon

Acting Director

Department of Social Services
White Mountain Apache Tribe
P.O. Box 1870
Whiteriver, Arizona 85941
Phone: 928-338-4164
Email: mclendon@wmat.us

Gloria Cobb

Economic Support Director

Economic Support Office
Lac du Flambeau Band of Lake Superior Chippewa
418 Little Pines Road
P.O. Box 67
Lac du Flambeau, Wisconsin 54538
Phone: 715-588-4235
Email: gcobb@ldftribe.com

Leslie M. Colegrove

Executive Director

Hoop Valley Tribal TANF Program
Hoop Valley Tribe
P.O. Box 728
Hoop, California 95546
Phone: 530-625-4816
Email: leslie.colegrove@hoopatanf.com

Wendy M. Corbine

Tribal TANF Program Manager

Bad River Social and Family Services
Bad River Band of Lake Superior Chippewa
P.O. Box 55
Odanah, Wisconsin 54861
Phone: 715-682-7127
Email: fep@badriver-nsn.gov

Ronald Cordes

Finance Director

Fiscal Department
Tuolumne Band of Me-Wuk Indians
19595 Mi-Wu Street
P.O. Box 615
Tuolumne, California 95379
Phone: 209-928-5360
Email: rcordes@mewuk.com

Lynne Cosgrove

Accounts Analyst

Fiscal Department
Tuolumne Band of Me-Wuk Indians
19595 Mi-Wu Street
P.O. Box 619
Tuolumne, California 95379
Phone: 209-928-5348
Email: lcosgrove@mewuk.com

Chiara C. Cournoyer

Social Services Program Manager

Winnebago Tribe of Nebraska
P.O. Box 771
Winnebago, Nebraska 68071
Phone: 402-878-2447
Email: chiara.cournoyer@winnebagotribe.com

Darlene Crabtree

Executive Director

Scotts Valley Tribal TANF Program
Scotts Valley Band of Pomo Indians
2727 Systron Drive, Suite 100
Concord, California 94518
Phone: 925-363-4778
Email: dcrabtree@svtribaltanf.org

Joe Dukepoo

Tribal Council Member

Round Valley Tribal TANF Program
Round Valley Indian Tribe
P.O. Box 217
Covelo, California 95428
Phone: 707-983-6127
Email: jdukepoo@rvit.org

Marisa M. Cummings

Chief of Tribal Operations

Omaha Tribe of Nebraska
P.O. Box 368
Macy, Nebraska 68039
Phone: 402-922-3168
Email: mcummings@omahatribe.com

Erin J. Duran

Tribal TANF Administrator

Northern Arapaho Nation Department
of Social Services
Northern Arapaho Tribe of the
Wind River Reservation
230 West Main Street
Riverton, Wyoming 82501
Phone: 307-257-2436
Email: eduran.nandss@gmail.com

Tilford P. Denver

Intergovernmental Affairs Administrator

Owens Valley Career Development Center
2574 Diaz Lane
P.O. Box 847
Bishop, California 93514
Phone: 760-873-5107
Email: tdenver@ovcdc.com

Patti Eagle

Assistant 477 Director

Eastern Shoshone 477 Program
Eastern Shoshone Tribe of the
Wind River Reservation
P.O. Box 1210
Fort Washakie, Wyoming 82514
Phone: 307-332-8052
Email: p.clair@eshoshone.com

Elaine Descheeny

Family Support Specialist

Hopi Family Assistance Program
Hopi Tribe
P.O. Box 123
Kykotsmovi, Arizona 86039
Phone: 928-734-2202
Email: edescheeny@yahoo.com

Colleen Faden

Tribal Council Representative

White Mountain Apache Tribe
P.O. Box 700
Whiteriver, Arizona 85941
Phone: 928-338-2513
Email: cfaden@wmat.us

Angela Diaz

Manager

Soboba Tribal TANF Program
1425 Spruce Street, Suite A
Riverside, California 92507
Phone: 951-654-5964
Email: adiaz@soboba-nsn.gov

Andrew K. Freed

TANF Senior Manager

Employment Training Services Department
Cook Inlet Tribal Council
3600 San Jeronimo Drive
Anchorage, Alaska 99508
Phone: 907-793-3315
Email: afreed@citci.org

Elizabeth K. Gobert

TANF/General Assistance Coordinator

Blackfeet Manpower
Tribal TANF
Blackfeet Nation
P.O. Box 1090
Browning, Montana 59417
Phone: 406-338-2111
Email: lizgobert60@yahoo.com

Roxanne Gorman

Department Manager III

Department for Self Reliance
Navajo Nation
P.O. Box 2279
Window Rock, Arizona 86515
Phone: 928-810-8553
Email: roxanne.gorman@nntanf.org

Nicole Grogan

Case Management Supervisor

Muscogee (Creek) Nation
P.O. Box 580
Okmulgee, Oklahoma 74447
Phone: 918-732-7982
Email: ngrogan@mcn-nsn.gov

Katrina Guitierrez

Tribal Council Secretary

North Fork Rancheria
33143 Road 222
North Fork, California 93643
Phone: 559-877-5530
Email: kguitierrez@nfr-nsn.gov

Cindy P. Hoaglen

Director

Tribal TANF Program
Round Valley Indian Tribe
P.O. Box 217
Covelo, California 95428
Phone: 707-983-6100
Email: choaglen@rvtt.net

Eric Hoaglin

Tribal Council Member

Round Valley Tribal TANF Program
Round Valley Indian Tribe
77826 Covelo Road
Covelo, California 95428
Phone: 707-983-6127
Email: ehoaglin@rvit.org

Ryan Howard

TANF Director

Owens Valley Career Development Center
P.O. Box 847
Bishop, California 93515
Phone: 760-873-5107
Email: rhoward@ovcdc.com

Donna M. Isham

Case Manager

Tribal TANF Program
Lac Courte Oreilles Chippewa Tribe
13394 West Trepania Road
Hayward, Wisconsin 54843
Phone: 715-634-8934
Email: donna.isham@lco-nsn.gov

Susan A. Jamerson

Executive Director

Tribal TANF Program
Washoe Tribe of Nevada and California
1246 Waterloo Lane
Gardnerville, Nevada 89410
Phone: 775-782-6320
Email: sjamerson@washoetanf.org

Teela James

Program Manager

Yurok Tribe
190 Klamath Boulevard
Klamath, California 95548
Phone: 707-482-1350
Email: teela@yuroktribe.nsn.us

Susie Johnson

Fiscal Officer

Southern California Tribal Chairmen's Association
P.O. Box 1470
Valley Center, California 92082
Phone: 760-742-8600
Email: sjohnson@sctca.net

Whitney Jones

Deputy Executive Director

South Puget Intertribal Planning Agency
3104 Southeast Old Olympic Highway
Shelton, Washington 98584
Phone: 360-462-3202
Email: wjones@spipa.org

Michael Kafka

Executive Director

Department of Labor
Mille Lacs Band of Ojibwe
43408 Oodena Drive
Onamia, Minnesota 56359
Phone: 320-532-7563
Email: michael.kafka@millelacsband.com

Zoltanica S. Kallestewa

Case Manager

Zuni Education Career Development Center
Pueblo of Zuni
P.O. Box 339
Zuni, New Mexico 87327
Phone: 505-782-5998
Email: Zoltanica.Kallestewa@ashiwi.org

Adele Kinley

ETC Program Manager

Lummi Family Services
Lummi Nation
2665 Kwina Road
Bellingham, Washington 98226
Phone: 360-312-2089
Email: topsyk@lummi-nsn.gov

Warren Kontz

Program Manager

Department of Social Services
Life Enhancement and Resource Network
Salt River Pima-Maricopa Indian Community
10005 East Osborn Road
Scottsdale, Arizona 85296
Phone: 480-362-5680
Email: warren.kontz@srpmic-nsn.gov

Karen M. Kyle

Administrative Officer

Hoopa Valley Tribal TANF Program
Hoopa Valley Tribe
P.O. Box 728
Hoopa, California 95546
Phone: 530-6254816
Email: Karen.kyle@hoopatanf.com

Jody LaMere

Councilwoman

Chippewa Cree Tribe Business Committee
Chippewa Cree Tribe of Rocky Boy's Reservation
31 Agency Square
Box Elder, Montana 59521
Phone: 406-395-4478
Email: jlamere@cct.rockyboy.org

Teresa LeBeau

TANF Director

Shingle Springs Tribal TANF Program
Shingle Springs Band of Miwok Indians
2033 Howe Avenue, Suite 100
Sacramento, California 95825
Phone: 916-760-1660
Email: tlebeau@sstanf.org

Deborah McConnell

Project Coordinator

Hoopa Valley Tribal TANF Program
Hoopa Valley Tribe
P.O. Box 728
Hoopa, California 95546
Phone: 530-625-4816
Email: deborah.mcconnell@hoopatanf.com

Carissa M. Livingston

TANF Case Manager

Bad River Tribal TANF Program
Bad River Band of Lake Superior Chippewa
P.O. Box 55
Odanah, Wisconsin 54861
Phone: 715-682-7127
Email: TANFasst@badriver-nsn.gov

Maryann McGovran

Tribal Council Chairperson

North Fork Rancheria
P.O. Box 929
North Fork, California 93643
Phone: 559-877-5534
Email: mmcgovran@nfr-nsn.gov

Anna Luna

Senior Social Worker

Department of Social Services
Life Enhancement and Resource Network
Salt River Pima-Maricopa Indian Community
10005 East Osborn Road
Scottsdale, Arizona 85256
Phone: 480-362-5680
Email: anna.luna@srpmic-nsn.gov

Milton T. Miller, Sr.

Tribal TANF Caseworker

Omaha Tribe of Nebraska
P.O. Box 368
Macy, Nebraska 68039
Phone: 402-837-4473
Email: mmiller@omahatribe.com

Melanie L. Luna

TANF Sites Director

Southern California Tribal Chairmen's Association
P.O. Box 1470
Valley Center, California 92082
Phone: 760-742-8606
Email: mluna@sctca.net

Misty R. Mills

TANF Administrator

Department of Social Services
White Mountain Apache Tribe
P.O. Box 1870
Whiteriver, Arizona 85941
Phone: 928-338-4164
Email: mistymills@wmat.us

Terreleene G. Massey

Division Director

Division of Social Services
Navajo Nation
P.O. Box 4590
Window Rock, Arizona 86515
Phone: 928-871-6851
Email: tmassey@navajo-nsn.gov

Stacy Mills

Family Assistance Program Manager

Children and Family Services
Community Services Division
Port Gamble S'Klallam Tribe
31912 Little Boston Road Northeast
Kingston, Washington 98346
Phone: 360-297-9650
Email: stacym@pgst.nsn.us

Cassandra A. Mitchell

Tribal Services Manager

Federated Indians of Graton Rancheria
6400 Redwood Drive, Suite 300
Rohnert Park, California 94928
Phone: 707-566-2288
Email: cmitchell@gratonrancheria.com

Jackie Morgan

Case Manager

Blackfeet Manpower
Blackfeet TANF
Blackfeet Nation
P.O. Box 1090
Browning, Montana 59417
Phone: 406-338-2111
Email: jckmrg_slrse@yahoo.com

Raquel Morris

TANF Director

Tribal TANF
Omaha Tribe of Nebraska
P.O. Box 368
Macy, Nebraska 68039
Phone: 402-837-4473
Email: Raquel.Morris@omahatribe.com

Roger Mowbray

Deputy Director

Sierra Nevada Region
Washoe Native TANF Program
Washoe Tribe of Nevada and California
1246 Waterloo Lane
Gardnerville, Nevada 89521
Phone: 775-782-6320
Email: rmowbray@washoetanf.org

Cindy D. Myers

Interim Director

Tribal TANF Program
Santo Domingo Pueblo
P.O. Box 152
Santo Domingo Pueblo, New Mexico 87052
Phone: 505-331-9826
Email: cmyers@kewa-nsn.us

Kayla J. Namoki

Secretary II

Hopi Family Assistance Program
Hopi Tribe
P.O. Box 123
Kykotsmovi, Arizona 86039
Phone: 928-734-2202
Email: Kayla.Namoki@pa-angni.com

Elizabeth A. Nasewytewa

Supervisor

Hopi Family Assistance Program
Hopi Tribe
P.O. Box 123
Kykotsmovi, Arizona 86039
Phone: 928-734-2202
Email: Elizabeth.Nasewytewa@pa-angni.com

Angela Osborne

Case Manager

Department Social Services
Tuolumne Band of Me-Wuk Indians
19595 Mi-Wu Street
P.O. Box 615
Tuolumne, California 95379
Phone: 209-928-5356
Email: aosborne@mewuk.com

Deborah A. Ost

Lead Caseworker - Spokane Site

477/TANF Program
Spokane Tribe of Indians
East 232 Lyons Avenue
Spokane, Washington 99208
Phone: 509-533-1360
Email: elvis@spokanetribe.com

Bernadette Panteah

Director, Education & Training

Zuni Education & Career Development Center
Pueblo of Zuni
P.O. Box 339
Zuni, New Mexico 87327
Phone: 505-782-5998
Email: Bernadette.Panteah@ashiwi.org

Debra L. Powless

Area Manager

Social Services Division
Oneida Tribe of Indians of Wisconsin
P.O. Box 365
Oneida, Wisconsin 54155
Phone: 920-445-4780
Email: dpowles2@oneidanation.org

Ora Parker

TANF Case Manager

Winnebago Tribe of Nebraska
600 Fourth Street, Suite 222
Sioux City, Iowa 51101
Phone: 712-233-1227
Email: ora.parker@winnebagotribe.com

Stacie Racho

Youth Case Coordinator

Tribal TANF of Sonoma and Marin
Federated Indians of Graton Rancheria
6400 Redwood Drive, Suite 104
Rohnert Park, California 94928
Phone: 707-586-6100
Email: SRacho@gratonrancheria.com

Jo Ann Peck

Program Compliance Officer
Washoe Native TANF Program
Washoe Tribe of Nevada and California
1246 Waterloo Lane
Gardnerville, Nevada 89410
Phone: 775-782-6320
Email: jpeck@washoetanf.org

Michelle R. Sangrey

Fiscal Manager

Tribal TANF
Chippewa Cree Tribe of Rocky Boy's Reservation
31 Agency Square
Box Elder, Montana 59521
Phone: 406-395-5814
Email: michellesangrey@yahoo.com

Mark Pendergrass

Office Manager
Tribal TANF Program
Muscogee (Creek) Nation
P.O. Box 580
Okmulgee, Oklahoma 74447
Phone: 918-732-7982
Email: mpendergrass@mcn-nsn.gov

Christie Schmidt

Lead Worker

Economic Support Division
Forest County Potawatomi Community
5415 Everybody's Road
P.O. Box 340
Crandon, Wisconsin 54520
Phone: 715-478-7206
Email: christie.schmidt@fcpotawatomi-nsn.gov

Lisa Pendleton

Tribal Council Member
Robinson Rancheria
California Tribal TANF Partnership
991 Parallel Drive, Suite B
Lakeport, California 95453
Phone: 707-262-4400
Email: lpendleton@cttp.net

Jeff Schueller

Executive Director

Robinson Rancheria
991 Parallel Drive, Suite B
Lakeport, California 95453
Phone: 707-262-4400
Email: jschueller@cctp.net

Trina Schuyler

Economic Support Director

Department of Social Services
Oneida Tribe of Indians of Wisconsin
P.O. Box 365
Oneida, Wisconsin 54165
Phone: 920-490-3776
Email: TSchuyler@oneidanation.org

Richard L. Sherwood

Wellpinit Site Manager

TANF Program
Spokane Tribe of Indians
P.O. Box 100
Wellpinit, Washington 99040
Phone: 509-458-8004
Email: rickys@spokanetribe.com

Loretta A. St.Germaine

TANF Caseworker

Economic Support Office
Lac du Flambeau Band of Lake Superior Chippewa
418 Little Pines Road
P.O. Box 67
Lac du Flambeau, Wisconsin 54538
Phone: 715-588-4235
Email: LSt.Germaine@ldftribe.com

Elaine R. TopSky

Program Manager

Chippewa Cree Tribal TANF
Human Services Department
Chippewa Cree Tribe of Rocky Boy's Reservation
31 Agency Square
Box Elder, Montana 59521
Phone: 406-395-5814
Email: elaine.topsky@gmail.com

Denis Turner

Executive Director

Southern California Tribal Chairmen's Association
P.O. Box 1470
Valley Center, California 92082
Phone: 760-742-8600
Email: mrdenisturner@aol.com

Alyne S. Turner

TANF Case Manager

TANF Program
Eastern Band of Cherokee Indians
145 Cornsilk Branch Road
Robbinsville, North Carolina 28771
Phone: 828-479-1000
Email: aturner@1fsic.com

Mark Ulibarri

Accounts Analyst

Fiscal Department
Tuolumne Band of Me-Wuk Indians
19595 Mi-Wu Street
P.O. Box 615
Tuolumne, California 95379
Phone: 209-928-5300
Email: mulibarri@mewuk.com

John Wadda

Tribal 477 Director

477 Program
Eastern Shoshone Tribe of the
Wind River Reservation
P.O. Box 1210
Fort Washakie, Wyoming 82514
Phone: 307-332-8052
Email: jewadda@eshoshone.com

Dorothy Wait

Director

Community and Family Services
Smith River Rancheria
140 Rowdy Creek
Smith River, California 95567
Phone: 707-487-9255
Email: dperry@tolowa.com

Rae B. Whitcomb

Director

Workforce Development
Bristol Bay Native Association
P.O. Box 310
Dillingham, Alaska 99576
Phone: 907-842-2262
Email: rwhitcomb@bbna.com

Alexander Yazza

Executive Director

Owens Valley Career Development Center
2574 Diaz Lane
P.O. Box 847
Bishop, California 93514
Phone: 760-873-5107
Email: ayazza@ovcdc.com

Cristy A. Willer

Chief Operating Officer

Cook Inlet Tribal Council
3600 San Jeronimo Drive
Anchorage, Alaska 99508
Phone: 907-793-3421
Email: cwiller@citci.org

SPEAKERS

Amanda Ahlstrand

Administrator

U.S. Department of Labor
Employment and Training Administration,
Office of Workforce Investment
200 Constitution Avenue, NW, Room C4526
Washington, District of Columbia 20210
Phone: 202-693-3980
Email: ahlstrand.amanda@dol.gov

Matthew Barnes

Program Services Director

California Tribal TANF Partnership
Program Services
991 Parallel Drive, Suite B
Lakeport, California 95453
Phone: 707-262-4400
Email: mbarnes@cttp.net

Athena R. Brown

Division Chief

U.S. Department of Labor
Division of Indian and Native American Programs
200 Constitution Avenue, NW, Room C-4311
Washington, District of Columbia 20210
Phone: 202-693-3737
Email: brown.athena@dol.gov

Rondelle Clay

Regional Director

Eastern Region Training and Assistance Center
Administration for Native Americans/
Centers for Medicare and Medicaid Services
1800 Robert Fulton Drive, Suite 100C
Reston, Virginia 20191
Phone: 571-323-5659
Email: rclay@namsinc.org

Stephen Cornell

Professor

The University of Arizona
Udall Center for Studies in Public Policy
803 East First Street
Tucson, Arizona 85719
Phone: 520-349-8054
Email: scornell@email.arizona.edu

Stacey Ecoffey

Principal Advisor for Tribal Affairs

U.S. Department of Health and Human Services
Immediate Office of the Secretary
Office of Intergovernmental Affairs
200 Independence Avenue, SW
Washington, District of Columbia 20021
Phone: 202-690-7410
Email: Stacey.Ecoffey@hhs.gov

Lesla Evers

Tribal Relations Manager

Montana Department of Public Health
and Human Services
Office of the Director
P.O. Box 4210
Helena, Montana 59604
Phone: 406-444-1813
Email: levers@mt.gov

Anita Fineday

Managing Director

Casey Family Programs
2001 Eighth Avenue, Suite 2700
Seattle, Washington 98121
Phone: 218-850-2210
Email: Afineday@casey.org

Felicia Gaither

Director

U.S. Department of Health and Human Services
Administration for Children and Families,
Office of Family Assistance
Division of Tribal TANF Management
370 L'Enfant Promenade, SW
Washington, District of Columbia 20447
Phone: 202-205-8354
Email: felicia.gaither@acf.hhs.gov

Mark Greenberg

Acting Assistant Secretary

U.S. Department of Health and Human Services
Administration for Children and Families
370 L'Enfant Promenade, SW
Washington, District of Columbia 20447
Phone: 202-401-5383
Email: mark.greenberg@acf.hhs.gov

Liliana Hernandez

Family Assistance Program Specialist

U.S. Department of Health and Human Services
Administration for Children and Families
Office of Family Assistance
370 L'Enfant Promenade, SW
Washington, District of Columbia 20447
Phone: 202-358-2405
Email: liliana.hernandez@acf.hhs.gov

Jodie Sue Kelly

President

Cygnnet Associates
101 Hickory Lane
Annapolis, Maryland 21403
Phone: 410-263-8515
Email: cygnnet84@aol.com

Stan Koutstaal

Program Manager

U.S. Department of Health and Human Services
Administration for Children and Families
Office of Family Assistance
Health Profession Opportunity Grants
370 L'Enfant Promenade, SW
Washington, District of Columbia 20447
Phone: 202-401-5457
Email: stanley.koutstaal@acf.hhs.gov

Denise Litz

Family Assistance Program Specialist

U.S. Department of Health and Human Services
Administration for Children and Families
Office of Family Assistance
370 L'Enfant Promenade, SW
Washington, District of Columbia 20447
Phone: 202-401-6971
Email: denise.litz@acf.hhs.gov

Joseph S. Nayquonabe

Commissioner of Corporate Affairs/CEO

Mille Lacs Corporate Ventures
700 Grand Avenue
Onamia, Minnesota 56359
Phone: 320-532-8882
Email: jnayquonabe@mlcorporateventures.com

Connie Park

Senior Research Associate

James Bell Associates, Inc.
3033 Wilson Boulevard, Suite 650
Arlington, Virginia 22201
Phone: 703-528-3230
Email: park@jbassoc.com

Nisha Patel

Director

U.S. Department of Health and Human Services
Administration for Children and Families
Office of Family Assistance
370 L'Enfant Promenade, SW
Washington, District of Columbia 20447
Phone: 202-401-9276
Email: nisha.patel@acf.hhs.gov

Heather Zenone

Senior Advisor, Tribal Children

U.S. Department of Health and Human Services
Administration for Children and Families
Children's Bureau
1250 Maryland Avenue, SW
Washington, District of Columbia 20024
Phone: 202-205-2629
Email: heather.zenone@acf.hhs.gov

Don M. Shircel

Director

Tanana Chiefs Conference
Client Development
122 First Avenue, Suite 600
Fairbanks, Alaska 99701
Phone: 907-452-8251
Email: don.shircel@tananachiefs.org

Dennis Zotigh

Cultural Specialist

Smithsonian's National Museum of
the American Indian
4th Street and Independence Avenue, SW
Washington, District of Columbia 20560

Lillian Sparks Robinson

Commissioner

U.S. Department of Health and Human Services
Administration for Children and Families
Administration for Native Americans
370 L'Enfant Promenade, SW
Washington, District of Columbia 20447
Phone: 202-401-5590
Email: Lillian.sparks@acf.hhs.gov

FEDERAL PARTNERS

Gary J. Allen

Regional Program Manager

U.S. Department of Health and Human Services
Administration for Children and Families
Office of Family Assistance, Region VII
601 East 12th Street, Room 349
Kansas City, Missouri 64106
Phone: 816-426-2236
Email: gary.allen@acf.hhs.gov

Frances Dixon

TANF Program Specialist

U.S. Department of Health and Human Services
Administration for Children and Families
Office of Family Assistance, Region V
233 North Michigan Avenue, Suite 400
Chicago, Illinois 60601
Phone: 312-886-4924
Email: frances.dixon@acf.hhs.gov

Akenabah Begay

Intergovernmental Liaison Assistant

U.S. Census Bureau
Office of Congressional and Intergovernmental
Affairs
4600 Suitland Road
Suitland, Maryland 20233
Phone: 301-763-9385
Email: akenabah.begay@census.gov

Tracy Donovan

Program Specialist

U.S. Department of Health and Human Services
Administration for Children and Families
Office of Family Assistance, Region IX
90 Seventh Street
San Francisco, California 94103
Phone: 415-437-8424
Email: tracy.donovan@acf.hhs.gov

James Butler

Program Specialist

U.S. Department of Health and Human Services
Administration for Children and Families
Office of Family Assistance
370 L'Enfant Promenade, SW
Washington, District of Columbia 20447
Phone: 202-401-9284
Email: james.butler@acf.hhs.gov

Julie A. Fong

Region IX TANF Program Manager

U.S. Department of Health and Human Services
Administration for Children and Families
Office of Family Assistance, Region IX
90 Seventh Street
San Francisco, California 94103
Phone: 415-437-7579
Email: julie.fong@acf.hhs.gov

John C. Disque

TANF Program Specialist

U.S. Department of Health and Human Services
Administration for Children and Families
Office of Family Assistance, Region VI
1301 Young Street, Room 945
Dallas, Texas 75202
Phone: 214-767-8077
Email: john.disque@acf.hhs.gov

Marjorie Hudspeth

Children and Families Program Specialist

U.S. Department of Health and Human Services
Administration for Children and Families
Office of Family Assistance, Region VIII
1961 Stout Street
Federal Office Building
Denver, Colorado 80294
Phone: 303-844-1159
Email: marjorie.hudspeth@acf.hhs.gov

Janelle J. Jones

TANF Program Specialist

U.S. Department of Health and Human Services
Administration for Children and Families
Office of Family Assistance, Region VIII
1961 Stout Street, #08-148
Denver, Colorado 80294
Phone: 303-844-7337
Email: Janelle.Jones@acf.hhs.gov

Theresa M. Renfrow

Program Specialist

U.S. Department of Health and Human Services
Administration for Children and Families
Office of Family Assistance, Region VII
601 East 12th Street, Suite 349
Kansas City, Missouri 64106
Phone: 816-426-2231
Email: theresa.renfrow@acf.hhs.gov

Alisa Matthews

Children and Families Program Specialist

U.S. Department of Health and Human Services
Administration for Children and Families
Office of Family Assistance, Region VI
1301 Young Street, Room 945
Dallas, Texas 75154
Phone: 214-767-8078
Email: alisa.matthews@acf.hhs.gov

Kisha Russell

TANF Regional Program Manager

U.S. Department of Health and Human Services
Administration for Children and Families
Office of Family Assistance, Region VIII
1961 Stout Street, 8th Floor
Denver, Colorado 80294
Phone: 303-844-1483
Email: kisha.russell@acf.hhs.gov

Larry D. McDowell

TANF Program Specialist

U.S. Department of Health and Human Services
Administration for Children and Families
Office of Family Assistance, Region VI
1301 Young Street, Room 945
Dallas, Texas 75202
Phone: 214-767-7327
Email: larry.mcdowell@acf.hhs.gov

Tom Schindler

Regional Program Manager

U.S. Department of Health and Human Services
Administration for Children and Families
Office of Family Assistance, Region V
233 North Michigan Avenue
Chicago, Illinois 60601
Phone: 312-886-9540
Email: thomas.schindler@acf.hhs.gov

Judy A. Ogliore

Program Specialist

U.S. Department of Health and Human Services
Administration for Children and Families
Office of Family Assistance, Region X
701 Fifth Avenue, MS 71
Seattle, Washington 98104
Phone: 206-615-2568
Email: judy.ogliore@acf.hhs.gov

Lamonica Shelton

Regional Program Manager

U.S. Department of Health and Human Services
Administration for Children and Families
Office of Family Assistance, Region IV
61 Forsyth Street
Atlanta, Georgia 30303
Phone: 404-562-2938
Email: lamonica.shelton@acf.hhs.gov

Mikaela Smith

Family Assistance Program Specialist

U.S. Department of Health and Human Services
Administration for Children and Families
Office of Family Assistance, Region IX
90 Seventh Street
San Francisco, California 94103
Phone: 415-437-8418
Email: mikaela.smith@acf.hhs.gov

Lauren Supplee

Division Director

U.S. Department of Health and Human Services
Administration for Children and Families
Office of Planning, Research, and Evaluation
Division of Family Strengthening
370 L'Enfant Promenade, SW
Washington, District of Columbia 20447
Phone: 202-401-5434
Email: lauren.supplee@acf.hhs.gov

Lisa Washington-Thomas

Self-Sufficiency Branch Chief

U.S. Department of Health and Human Services
Administration for Children and Families
Office of Family Assistance
370 L'Enfant Promenade, SW
Washington, District of Columbia 20447
Phone: 202-401-5141
Email: lwashington-thomas@acf.hhs.gov

Damon Waters

Program Specialist

U.S. Department of Health and Human Services
Administration for Children and Families
Office of Family Assistance
370 L'Enfant Promenade, SW
Washington, District of Columbia 20447
Phone: 202-401-5295
Email: damon.waters@acf.hhs.gov

CONTRACT STAFF

Marissa Carmi

Outreach Specialist

Administration for Native Americans/Centers for Medicare and Medicaid Services, Healthy Tribes
1800 Robert Fulton Drive, Suite 100C
Reston, Virginia 20191
Phone: 571-323-5650
Email: mcarmi@namsinc.org

Kerry Carmichael

Senior Conference Planner

The Fain Group
6701 Democracy Plaza, Suite 300
Bethesda, Maryland 20817
Phone: 703-524-0410
Email: kerry@faingroup.com

Lynn M. Carrier

Senior Associate

ICF International
9300 Lee Highway
Fairfax, Virginia 22031
Phone: 703-225-2185
Email: lynn.carrier@icfi.com

Leslie Fain

Principal

The Fain Group
6701 Democracy Plaza, Suite 300
Bethesda, Maryland 20817
Phone: 301-942-5579
Email: leslie@faingroup.com

Rebecca Gorin

Research Assistant

ICF International
9300 Lee Highway
Fairfax, Virginia 22031
Phone: 703-225-2411
Email: rebecca.gorin@icfi.com

Patrick Heiman

Training and Technical Assistance Manager

ICF International
615 Southwest Alder Street, Suite 200
Portland, Oregon 97205
Phone: 240-723-0542
Email: patrick.heiman@icfi.com

Janet Kreitman

Health Writer/Editor

BLH Technologies, Inc.
1803 Research Boulevard, Suite 300
Rockville, Maryland 20850
Phone: 240-399-8460
Email: jkreitman@blhtech.com

Michael Meyer

Outreach Specialist

Administration for Native Americans/
Centers for Medicare and Medicaid Services
1800 Robert Fulton Drive, Suite 100C
Reston, Virginia 20191
Phone: 571-323-5650
Email: mmeyerdc@comcast.net

Nicole Wright

Research Assistant

ICF International
9300 Lee Highway
Fairfax, Virginia 22031
Phone: 703-713-8763
Email: nicole.wright@icfi.com

